

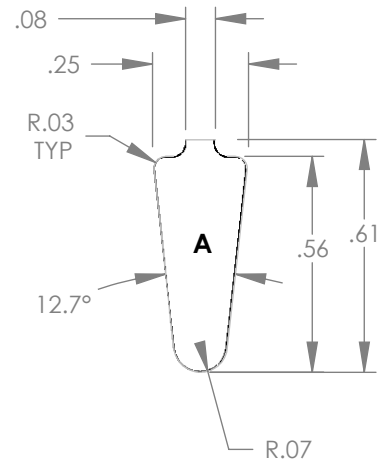

"MADE IN THE USA"

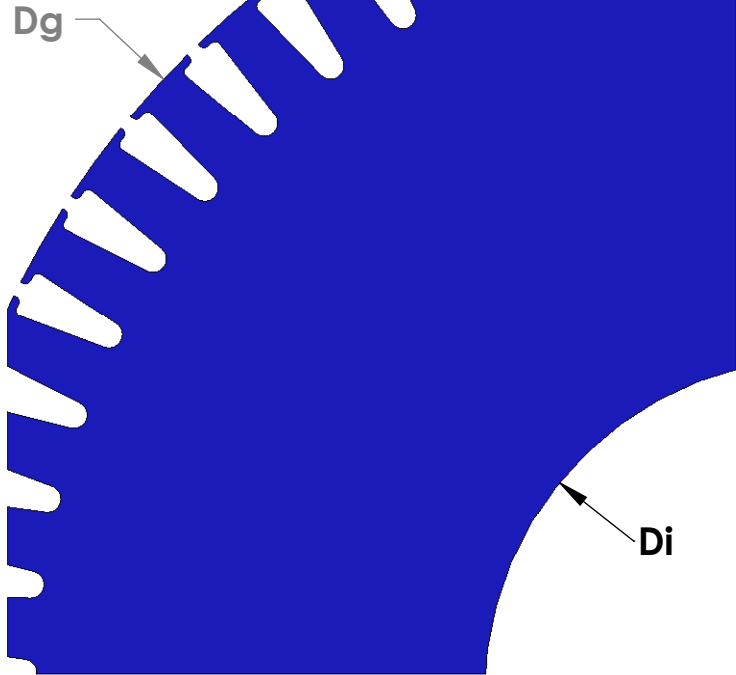

| ROTOR   | SLOT<br>H | CHARACTERISTICS |                |    |       |
|---------|-----------|-----------------|----------------|----|-------|
|         |           | D <sub>g</sub>  | D <sub>i</sub> | N  | A     |
| 42728-F |           | 9.38            | 2.75           | 57 | 0.107 |
| 42728-G |           | 9.38            | 3.00           | 57 | 0.107 |
| 42728-K |           | 9.38            | 6.00           | 57 | 0.107 |

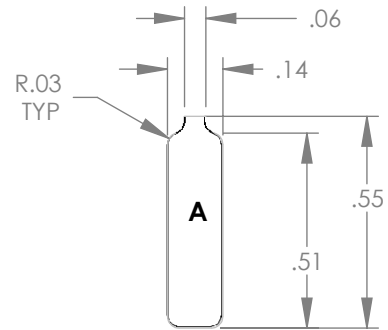
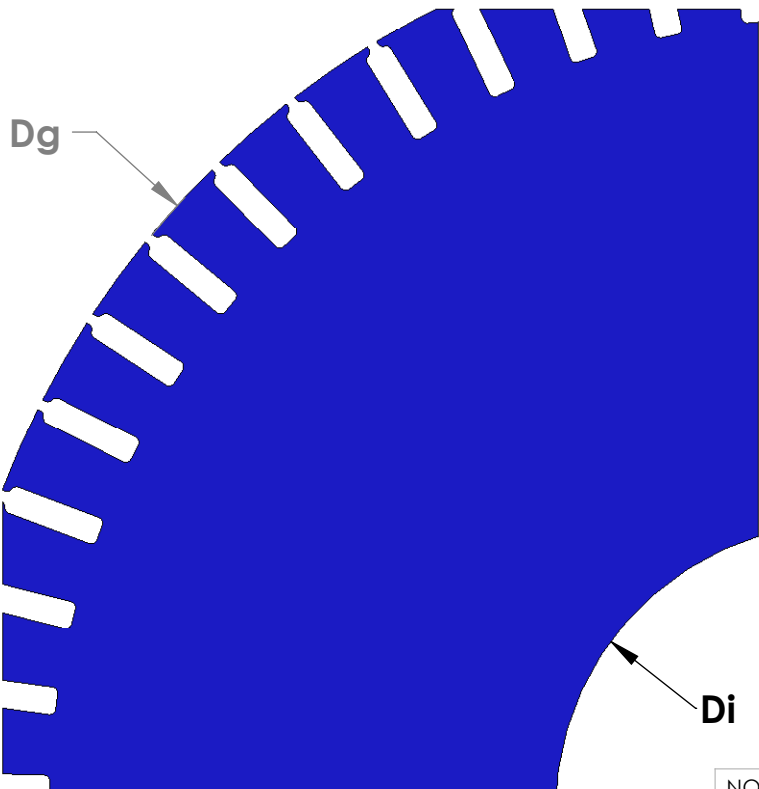

| ROTOR   | SLOT<br>L | CHARACTERISTICS |                |    |       |
|---------|-----------|-----------------|----------------|----|-------|
|         |           | D <sub>g</sub>  | D <sub>i</sub> | N  | A     |
| 42729-F |           | 9.38            | 2.75           | 57 | 0.075 |
| 42729-G |           | 9.38            | 3.00           | 57 | 0.075 |
| 42729-K |           | 9.38            | 6.00           | 57 | 0.075 |

NOTE: CORES ARE WELDED  
NOT TO SCALE

MATERIAL: SILICON STEEL  
DIMENSIONS: INCHES

**REULAND ELECTRIC CO.**  
INDUSTRY, CA    HOWELL, MI    CINCINNATI, OH

[www.reuland.com](http://www.reuland.com)

Copyright © 2009 Reuland Electric Co. 2009. All Rights Reserved.